



1D & 2D



Mobile Reading



Visual Feedback



IP42



1.5m drop



USB



EasySet



Warranty 5 Years



## FR27 Urchin

Presentation Scanners

## Features

### Superior self-service scanning from screen

The FR27 Urchin is primarily designed to be easy to use for self-service scanning from customers' phone screens. A remarkably wide field of view means even the largest codes presented on the largest phone screens are scanned easily.

### Snappy scanning from paper, metal and plastic

Printed barcodes are still used in many applications, so the FR27 Urchin makes sure it can cope with them. It maintains top performance with all types of 1D and 2D codes presented to it on paper, metal and plastic surfaces. Even curved and creased codes pose no challenge.

### Small and stylish

The FR27 Urchin packs all its scanning power into a small, sleek design. Making not only a great space saver but looking good while doing so. The scanner has a smooth and simple finish that blends well with any countertops design from boutique to café.

### Fast scanning with outstanding motion tolerance

The FR27 Urchin has an outstanding 2.7m per second motion tolerance for applications where fast scanning on moving codes is vital. Clearing lines of customers self-scanning or clearing baskets of items at the point of sale, the FR27 gives you more speed than ever before.

### Clear visual feedback

Using soft white illumination to scan barcodes, the FR27 Urchin also utilises its white background to project a green led, indicating a good read. Visual feed-back in a self-service application makes all the difference in giving customers confidence in achieving a successful scan.

### Flexible mounting options

Mindful that the FR27 Urchin can suit access control and kiosk applications, its case has a design that allows you to manipulate the cable for mounting portrait or landscape. It also has threaded fixing points for vertical mounting.

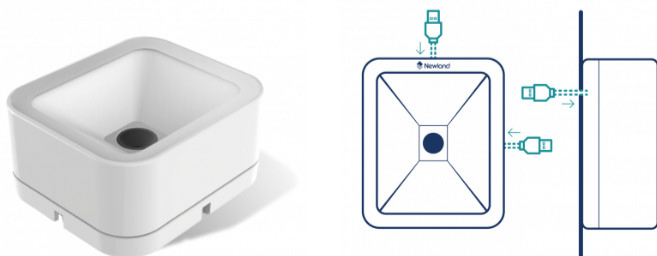

Available in white on request

## Suggested industries



Retail



Logistics



Hospitality



Entertainment

# FR27 Urchin Technical specifications

## Data Capture

1D	All major 1D symbologies.
2D	All major 2D symbologies, including QR Code, Data Matrix, Aztec, Micro PDF, Micro QR, PDF417.
Image Sensor	640x480 CMOS
Illumination	White LED
Scan Modes	Sense Mode, Continuous Mode
Depth of Field EAN 13 (13mil)	20mm-105mm
Depth of Field PDF417 (6.67mil)	30mm-40mm
Depth of Field DataMatrix (10mil)	30mm-45mm
Depth of Field QR (15mil)	0mm-85mm
Field of View Horizontal	68°
Field of View Vertical	vertical: 51° diagonal: 84.8°
Scan Angle Roll	360°
Scan Angle Pitch	±75°
Scan Angle Skew	±75°
Motion Tolerance	2.7 m/s
Minimal Print Contrast	20%

## Physical

Current @ 5VDC Operating	140mA (typical)
Current @ 5VDC Standby	100mA (typical)
Dimensions (mm)	66.3(W)x76.3(D)x38(H)mm (max.)
Input Voltage	5VDC±5%
Interfaces	USB
Power Consumption	698mW
Weight	120g

## Environmental

Ambient Light	0~100,000lux (natural light)
Operating Temperature	-20°C to 60°C (-4°F to 140°F)
Storage Temperature	-40°C to 70°C (-40°F to 158°F)
Humidity	5% to 95% (non-condensing)
Electro Static Discharge (ESD)	±12 kV (air discharge), ±8 kV (direct discharge)
Drop	1.5m
IP Rating	IP42

## Software

Configuration Tools	EasySet
---------------------	---------

## Certifications

Hardware	VCCI, RoHS, CE, FCC, RoHS
----------	---------------------------

### Warranty

Standard

5 years